

ROTHENBERGER

ROSPI H+E



Industrial Equipment Company

6112 North Mesa Street, Suite 127, El Paso, TX 79912

Ph. 866-566-0222, Fax. 915-228-3777

www.cmstools.us

7.1990

7.1995

7.2000

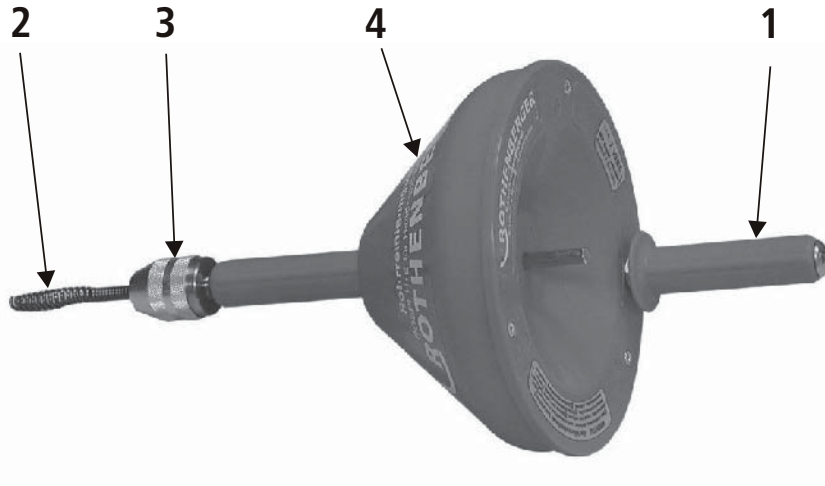

R

**1****2****3****4**

CMS
Industrial Equipment Company

6112 North Mesa Street, Suite 127, El Paso, TX 79912
Ph. 866-566-0222, Fax. 915-228-3777
www.cmstools.us

Proper usage

This device may only be used in accordance with the regulations as stated.
Universally deployable for the cleaning of all pipes with a Ø 10-55 mm pipe diameter.
Elimination of all obstructions in the drain pipes of sinks, hand wash basins, showers, bath tubs and toilets.

Safety instructions

If a drill is being used, the electrical installation must be checked at the workstation before putting into operation the pipe cleaning device. For this purpose please read the information in the operating instructions of the drill.

Accident prevention regulation!

Your attention please! If operating a drill, it is imperative that the crank handle is removed! Never use a drill without an electronic speed control - danger of accidents! Only use the counterclockwise rotation of the drill, when the spiral is secured in the pipe or in the event of its withdrawal!

Your attention please! Commence cleaning work with low rotational speed and increase if required.

Description

The Rospi H+E hand pipe cleaners are designed both for manual crank operation as well as for electrically driven operation by means of using a commercially available drill (not included in the scope of supplies). The flexible spiral, fitted with an extended operating head, is particularly suitable for using in narrow pipe bends and elbow joints.

Cleaning work in the sanitary area can be carried out without the removal of sink sieves or sanitary traps.

The closed, impact-resistant plastic spiral container prevents the accumulation of dirt in the working area.

The following versions are available:

<u>Designation</u>	<u>Product number</u>	<u>Spiral end diameter</u>	<u>Spiral length</u>
ROSPI 6 H+E	7.1990	6,4 mm	4,5 m
ROSPI 8 H+E	7.1995	8,0 mm	7,5 m
ROSPI 10 H+E	7.2000	10,0 mm	10 m

A - Overview

- 1 Crank handle
- 2 Spiral with extended operating head
- 3 Spiral clamping chuck / locking screw (ROSPI 6 H+E)
- 4 Spiral pot

Industrial Equipment Company
6112 North Mesa Street, Suite 127, El Paso, TX 79912
Ph. 866-566-0222, Fax. 915-228-3777
www.cmstools.us

B - Operating

If operating with a drill the crank handle must be removed, the central adapter-retaining pin (hexagon) should be mounted in the drill (Picture 2-3).

Pull the spiral out of the spiral container and insert it into the pipe, which is to be cleaned, until resistance (obstruction) becomes noticeable.

There must still be approx ca. 20 -30 cm of spiral between the cleaning device and the pipe opening. Tighten the spiral chuck!

Hold on to the handle on the cleaning device with one hand. Turn the spiral container to the right with the other hand with the help of the crank handle (Picture 1), or slowly start an electric, infinitely variable drill in motion in a clockwise direction (Picture 4).

Increase the rotational speed according to the cleaning problem.

Push the cleaning device with the rotating spiral at intervals against the obstruction.

Once the spiral has penetrated further into the pipe, stop the rotation (switch machine off), loosen the spiral chuck, pull the spiral out of the spiral container again by approx. 30 cm, tighten the spiral chuck and work again at intervals with the rotating spiral against the obstruction.

This process should be repeated for such periods until the obstruction is eliminated.

Taking out of service

The spiral is now pulled out, in a counterclockwise rotation, section by section from the pipe and once the clamping chuck has been loosened, pushed back into the container.

Approx. 10 - 15 cm of the spiral remain outside.

If operating a drill disconnect the power plug from the mains.

Care and maintenance

It is sensible to remove moisture and dirt arising from the cleaning of pipes from the spiral before it is pushed back into the spiral container. If this is not possible, the spiral should be completely pulled out of the container at regular intervals, cleaned and preserved with "ROWONAL".

New spirals must be bent at right angles to a length of approx. 10 cm at the rear end of the spiral, before being inserted into the container.

Your attention please!

Disconnect the power plug from the mains prior to all maintenance and upkeep work!

Do not use any cleaning agents containing solvents for cleaning of the plastic parts.

Accessories

The relevant accessories and an order form can be found from Page 22 onwards.

Disposal

Components of the unit are recyclable material and should be put to recycling. For this purpose registered and certified recycling companies are available. For an environmentalfriendly disposal of the non-recyclable parts (e.g. electronic waste) please contact your local waste disposal authority.

OPTIONAL

7.2522 ROSPI 6 H+E



Ø 6.4mm x 4.5m

7.2412 ROSPI 8-10 H+E



Ø 8mm x 7.5m (C1)

7.2413 ROSPI 8-10 H+E



Ø 8mm x 7.5m (C1/IC)

7.2414 ROSPI 8-10 H+E



Ø 8mm x 10m

7.2415 ROSPI 10 H+E



Ø 8mm x 10m

7.2422 ROSPI 10 H+E



Ø 10mm x 10m

7.2421 ROSPI 10 H+E



Ø 10mm x 7.5m

7.2140 ROWONAL 5,0 l

7.2142 ROWONAL 0,2 l



www.rothenberger.com

⊙ 9.0100

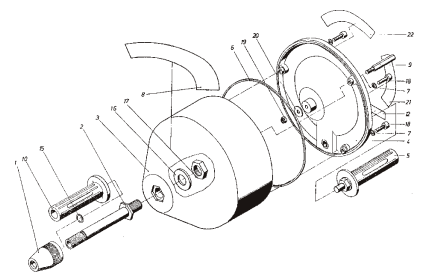

CMS

Industrial Equipment Company

6112 North Mesa Street, Suite 127, El Paso, TX 79912

Ph. 866-566-0222, Fax. 915-228-3777

www.cmstools.us

OPTIONAL

Zubehör und Ersatzteile / Accessories and spare parts

Bestellen Sie Ihre Zubehör- und Ersatzteile bei Ihrem Fachhändler
Order your accessories and spare parts from your specialist retailer

 Industrial Equipment Company 6112 North Mesa Street, Suite 127, El Paso, TX 79912 Ph. 866-566-0222, Fax. 915-228-3777 www.cmstools.us
Stempel / Stamp

Kunde / Anschrift Customer / address	
Kunden Nr. / customer no.	
Bestell Nr. / Order no.	
Ansprechpartner Contact person	
Tel.:	

Ihre Bestellung
Your order

Artikel Nr. / Article no.	Menge / Quantity	Bezeichnung / Description	Preis / Price

.....
Datum / Date

.....
Unterschrift / Signature



Notes

